

V-Flex

V-Flex is a brand of product series that is designed and developed by Brownie Ecotronics, mainly targeted for cove lighting application.

The perfect solution for general cove lighting. Available in CCT 2000K, 2500K, 2700K, 3000K, 3500K, 4000K and 6500K. All luminaires of these series are designed with dark spot-less in between fittings. The fixture length of this series is also customizable, perfect for vanity mirror and other indirect lighting.

DC24V

9.0W/m &
3.0W/m

IP65

Semi-Outdoor

Ra95 typ
(applicable for
CCT 2700K
above)

Dimmable

Custom
Length
(Build-to-order
basis)



FEATURES

- Perfect solution for general cove lighting.
- Available in CCT 2000K, 2500k, 2700K, 3000K, 3500K, 4000K and 6500K.
- Excellent efficiency using NICHIA Japan LED with optimized circuit design and tight-controlled chip's Vf properties.
- Dark spot-less in between fittings minimized voltage drop due to unique design of power compensation wire.
- Customized solution of different fixture length allows to apply to vanity mirror box and other indirect lighting.
- Excellent colour consistency MacAdam 3 Step Centre Binning (right on top of black locus body line).
- Two (2) types of wattage and brightness; 9.0W/m and 3.0W/m.
- Protection circuits equipped against reverse polarity.

BASIC SPECIFICATION

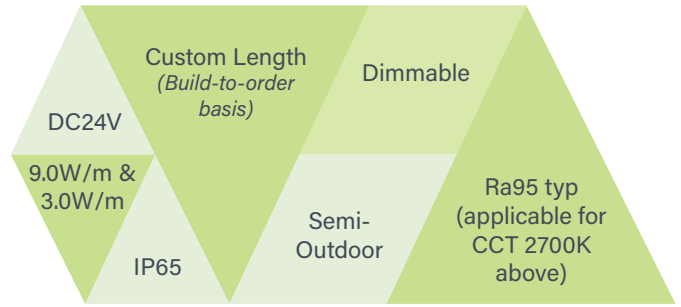

MECHANICAL DRAWING

① Approx.
3M = 15in-1

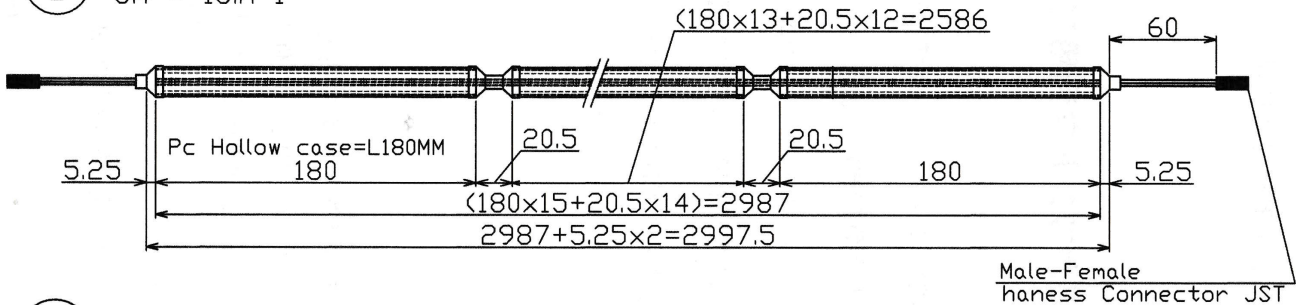

② Approx.
1M = 5in-1

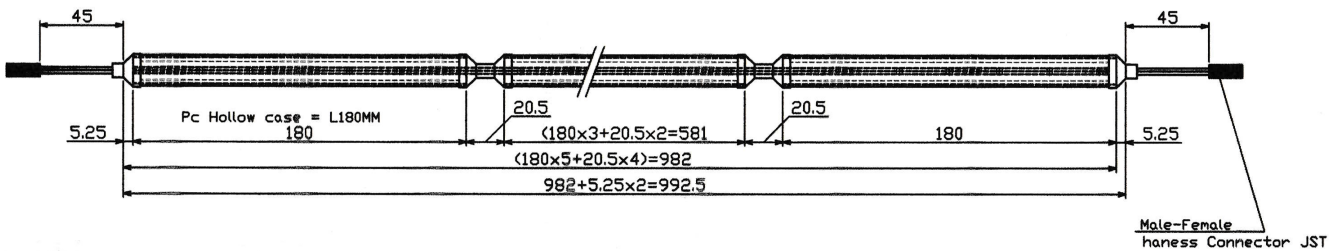

③ Approx.
0.6M = 3in-1

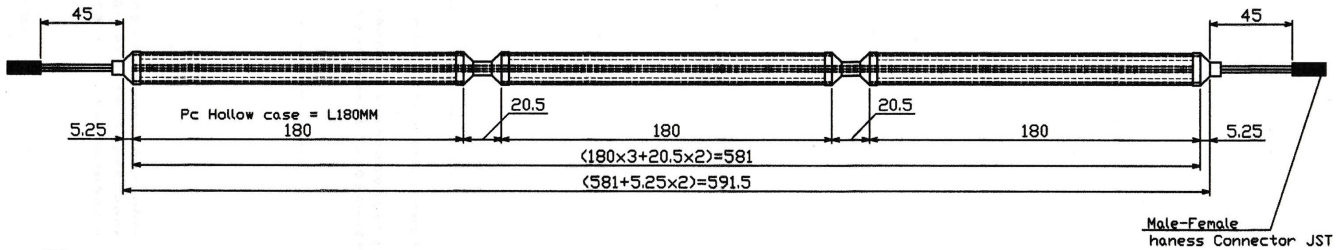

④ 200MM = 1in-1

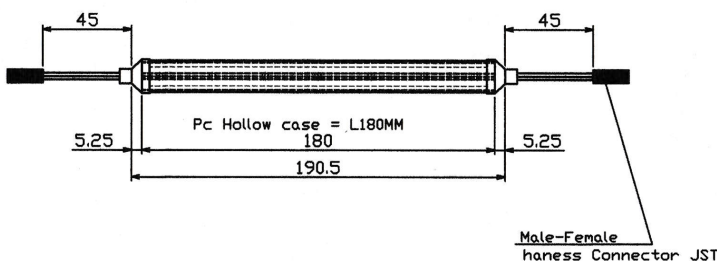

Male-Female Connector
(Standard Spec comes with this connector)

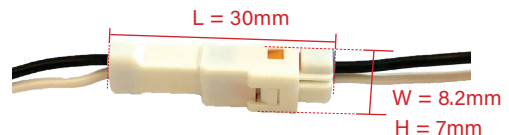

White /or Red Cable = Positive (+)
Black Cable = Negative (-)

⑤ Fixture Length 1M in one single case available

⇒ Spec detail refer to separate catalog spec V-FLEX 1M Single-Case

COMPETITIVE ADVANTAGE

1. Rigid Yet Flexible/Dark Spot-Less Design:

Electrical connection error or solder crack are very common problems found in conventional LED strips that uses flexible PCB. In order to eliminate these problems, V-Flex incorporates overmoulded polymer between pre-wired fixtures, thus greatly enhances product reliability and at the same time achieving uniform lighting effect that are free of dark spots in the typical cove application. The overmoulded polymer can be twisted and bent up to 180° at all X.Y.Z (omnidirectional) directions, further enhance the flexibility of application.

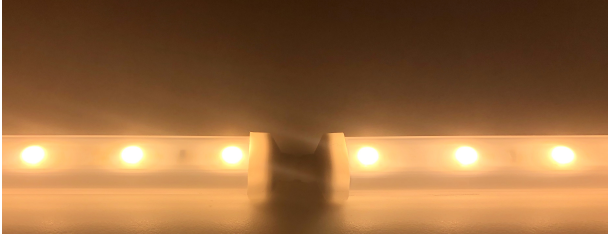

With min. 60mm distance between LED and the nearest illuminated surface, perfect uniformity is achieved

2. Wide Variety of Colour Temperature:

To accommodate various lighting requirement, V-Cove is available in 7 different types of colour temperature; 2000K, 2500K, 2700K, 3000K, 3500K, 4000K and 6500K. Not only that every LED chip is controlled within 3 Step MacAdam, furthermore every production batch falls right on top of black locus line that ensures the most natural light quality.

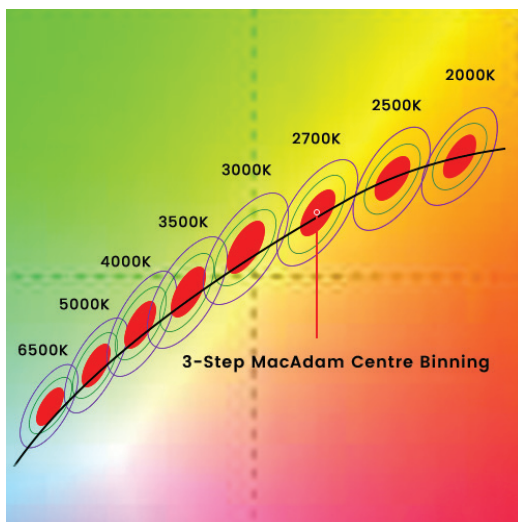

Nichia Chromaticity Diagram: Brownie Ecotronic is using the 3-Step MacAdam Centre Binning to ensure the excellent color consistency of our LED.

3. Uncompromised Light Quality and Colour Rendering:

Standard spec is Ra95 (typical) or minimum Ra90. By selecting extremely high colour rendering LED material, we intended to enhance the comfort to the lighting environment. (: Except CCT 2000K and CCT 2500K)

4. Minimized Voltage Drop:

Due to implementation of unique design of voltage drop compensation wire laid all the way through the casing body, possible voltage drop can be significantly reduced.

MODEL NO

Model No

XX **XXXX** – **XXX** **X** – **C**

Fixture Type

Fixture Length

Color Temperature

Type of LED used

Connector

Fixture Type

- VF** → V-Flex Standard (9.0W/m)
- VG** → V-Flex Low Wattage (3.0W/m), Build-to-order

Fixture Length

- 1000** → 1m L1000mm, **Standard**
- 0600** → L600mm, **Standard**
- 0200** → L200mm, **Standard**
- 1200** → L1200mm, Build-to-order
- 3000** → L3000mm, Build-to-order

Color Temperature

- 653** → Daylight 6500K
- 403** → Cool White 4000K
- 353** → 3500K
- 303** → Light Warm White 3000K
- 273** → Standard Warm White 2700K
- 253** → Dark Warm White 2500K
- 203** → Amber-Like Warm White 2000K

Type of LED used

- A** → Type A, manufactured by NICHIA Japan (Ra85 typ. For CCT 2500K & 2000K)
- B** → Type B, manufactured by NICHIA Japan (Ra95 typ. Except for CCT 2500K & 2000K)

Connector

- C** → with male-female connector, **Standard**

Example

VF

1000 – **303**

B – **C**

Fixture Type

Fixture Length

Color Temperature

Type of LED used

Connector

V-Flex 9.0W/m,
Standard

1 meter L1000mm,
Standard

Light Warm
White 3000K

Type B,
manufactured by
NICHIA Japan
(Ra95 typ.)

with male-
female
connector



PRODUCT SPECIFICATIONS

Product Name	V-Flex 9.0W/m (LED 27mm Pitch)			
Model No.	VF3000-xxx-C (L1000mm)	VF1000-xxx-C (L1000mm)	VF0600-xxx-C (L600mm)	VF0200-xxx-C (L200mm)
Input Voltage	24Vdc	24Vdc	24Vdc	24Vdc
Power Consumption	27.0 W	9.0 W	5.4 W	1.8 W
Dimension (mm)	3000*19*12(H)	1000*19*12(H)	600*19*12(H)	200*19*12(H)
Weight	570 grams	190 grams	112 grams	38 grams
Casing Body	Aluminium Heatsink with UV-resistant Polycarbonate Semi-Frosted Diffuser			
LED Beam Angle	110°	110°	110°	110°
Operating Temperature	-10°C~50°C	-10°C~50°C	-10°C~50°C	-10°C~50°C
Max. Length of Series Connection	6 meter	6 meter	6 meter	6 meter
Option Parts	Mounting clip bracket 0° (flat) type / 45° fixed angle type			
No of LEDs	105	35	21	7
Power Supply Unit (Gear-Driver)	24Vdc Constant-Voltage Switching Power Supply (TDK Lambda, Sold Separately)			
Dimmable Control	Dimmable	Dimmable	Dimmable	Dimmable
Lumens (typical @ 3000K)	3462	1154	692	230
Available LED Color				
Daylight 6500K <i>:: Build-to-order</i>	●	●	●	●
Cool White 4000K	●	●	●	●
3500K <i>:: Build-to-order</i>	●	●	●	●
Light Warm 3000K	●	●	●	●
Standard Warm 2700K	●	●	●	●
Dark Warm 2500K	●	●	●	●
Amber-Like Warm 2000K	●	●	●	●
RGB Full Color <i>:: Build-to-order</i>	NA	NA	NA	NA



PRODUCT SPECIFICATIONS

Product Name	V-Flex 3.0W/m (LED 27mm Pitch)			
Model No.	VG3000-xxx-C (L1000mm)	VG1000-xxx-C (L1000mm)	VG0600-xxx-C (L600mm)	VG0200-xxx-C (L200mm)
Input Voltage	24Vdc	24Vdc	24Vdc	24Vdc
Power Consumption	9.0 W	3.0 W	1.8 W	0.6 W
Dimension (mm)	3000*19*12(H)	1000*19*12(H)	600*19*12(H)	200*19*12(H)
Weight	570 grams	190 grams	112 grams	38 grams
Casing Body	Aluminium Heatsink with UV-resistant Polycarbonate Semi-Frosted Diffuser			
LED Beam Angle	110°	110°	110°	110°
Operating Temperature	-10°C~50°C	-10°C~50°C	-10°C~50°C	-10°C~50°C
Max. Length of Series Connection	10 meter	10 meter	10 meter	10 meter
Option Parts	Mounting clip bracket 0° (flat) type / 45° fixed angle type			
No of LEDs	105	35	21	7
Power Supply Unit (Gear-Driver)	24Vdc Constant-Voltage Switching Power Supply (TDK Lambda, Sold Separately)			
Dimmable Control	Dimmable	Dimmable	Dimmable	Dimmable
Lumens (typical @ 3000K)	1152	384	230	77
Available LED Color				
Daylight 6500K <i>:: Build-to-order</i>	●	●	●	●
Cool White 4000K	●	●	●	●
3500K <i>:: Build-to-order</i>	●	●	●	●
Light Warm 3000K	●	●	●	●
Standard Warm 2700K	●	●	●	●
Dark Warm 2500K	●	●	●	●
Amber-Like Warm 2000K	●	●	●	●
RGB Full Color <i>:: Build-to-order</i>	NA	NA	NA	NA

OPTIONAL ACCESSORIES

1 Mounting Clip Bracket 0° Flat Type

Model: MC-0DEG

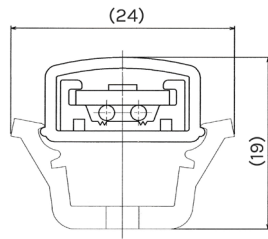
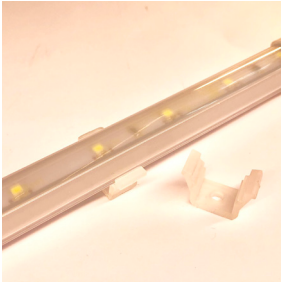

2 Mounting Clip Bracket 45° Type

Model: MC-45DEG

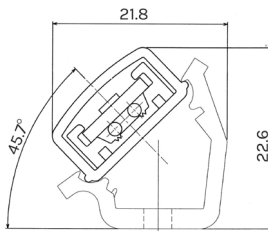

3 Metal Mounting Clip 30° Type

Model: MMC-30DEG

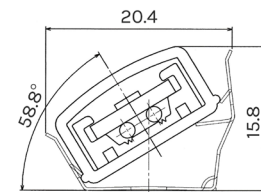

4 Aluminum Guide Rail

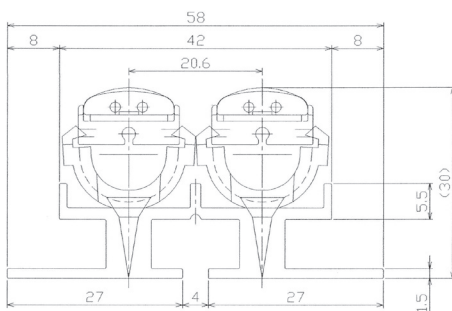
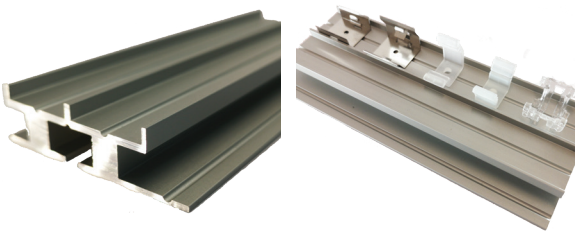

PHOTOMETRICS

BROWNIE Lab 190214

VF1000-303B-C

Article No.: VF1000-303B-C

Luminous flux (Luminaire): 1154 lm

Luminous flux (Lamps): 1154 lm

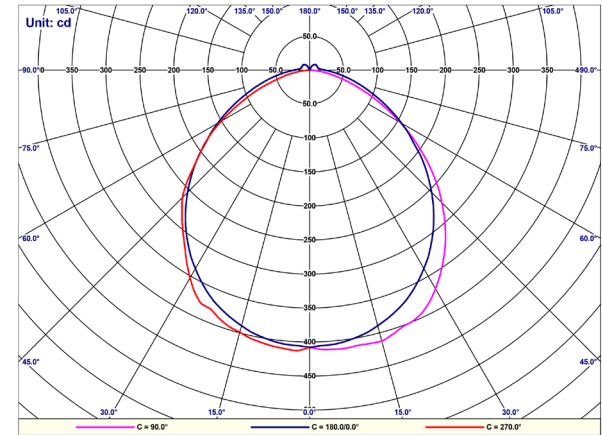

BROWNIE Lab 190215

VF0600-303B-C

Article No.: VF0600-303B-C

Luminous flux (Luminaire): 713 lm

Luminous flux (Lamps): 713 lm

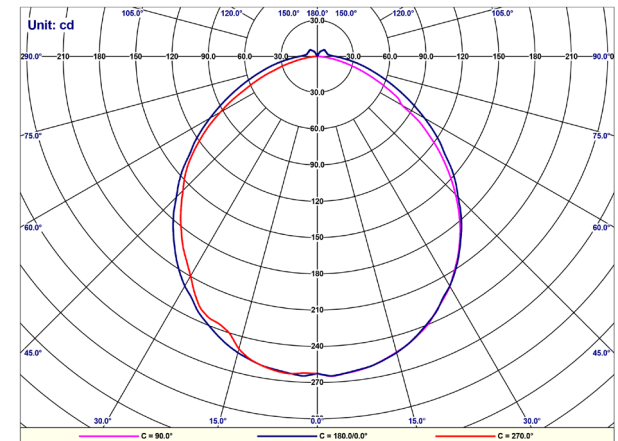

BROWNIE Lab 190223

VF0200-303B-C

Article No.: VF0200-303B-C

Luminous flux (Luminaire): 242 lm

Luminous flux (Lamps): 242 lm

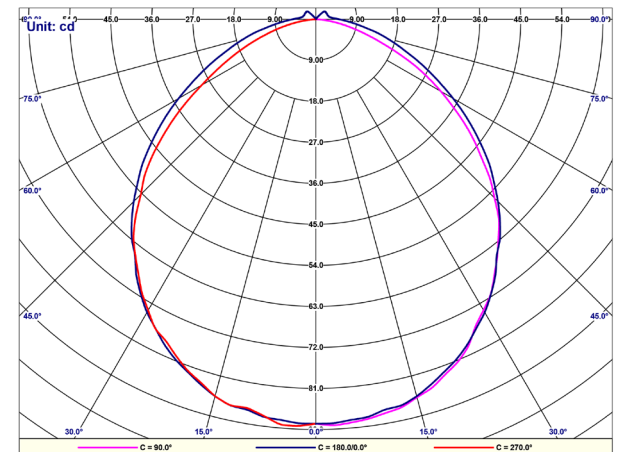

:: For IES data, please contact our sales staff or distributor

PROJECT REFERENCE



NUS HALL - Using V-Cove 3000K with DMX dimming driver - V-Dimmer-3

Photo by: Lighting Planners Associates



Kinokuniya Book Shop at Takashimaya using V-Cove (ver 1) 3000K